



ies

INTEGRATED ELECTRICAL SOLUTIONS

Trade PRICE LIST



ISO 9001-2000 CERTIFIED



VALID FROM JANUARY 2012

Integrated Electrical Solutions

In order to meet the demand of our customers, the IES product range continues to grow year on year. If the product you are looking for is not listed within our brochure, we invite you to call our sales team to discuss your exact requirements.



Services and solutions

Service quality is integral to our work ethos. Operating from a 30,000 sq ft facility enables IES to hold large stock levels to ensure fast delivery on all orders. Located in Avonmouth, Bristol, we are ideally positioned for nationwide distribution to our customers.

We aim to offer more than just a simple sales service. Qualified staff are on hand to answer any technical questions you may have, so please do not hesitate to contact us.

Why buy from IES?

- Technical product advice
- Next day delivery for ex-stock items
- Carriage paid on orders over £150 net
- Dedicated account management
- Bespoke solutions
- High quality products

Note our terms and conditions can be found on the inside back cover of the price list.

Our office opening times are from 8.30am to 5pm Monday to Friday.

If the product that you are looking for is not listed within our price list, we invite you to call our sales team to discuss your exact requirements.

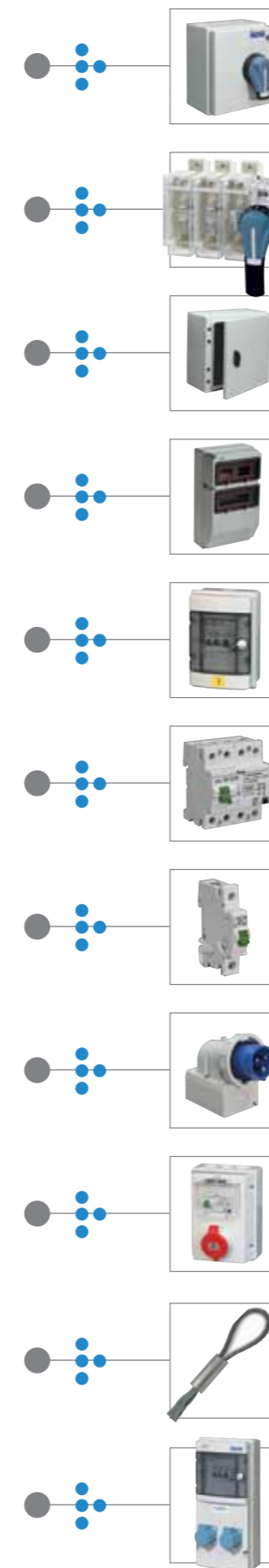

Contents

Switchgear - Enclosed	4
Switchgear - Loose	10
IP66 Metal Enclosures	12
IP66 GRP Enclosures IP55/67 Plastic Enclosures	14
IP55 Consumer Units	16
Protective Devices	17
MCB's	18
BSEN 60309 / BS4343 Plugs & Sockets	20
RCD Protected & Interlocked Sockets	28
Cable Grips	34
Caravan Units and Special Builds	36

Tel: 0845 226 7125
 Fax: 0117 938 0900
 Email: info@iese.co.uk

LOAD BREAK ISOLATORS METAL IP55* - 3 POLE & NEUTRAL

IES PART NO.	DESCRIPTION	DIMENSIONS	TRADE
421020	3P+N 20 Amp IP54	215(h) x 180(w) x 179(d)	£68.67
421032	3P+N 32 Amp IP54	215(h) x 180(w) x 179(d)	£77.26
421063	3P+N 63 Amp IP54	215(h) x 180(w) x 179(d)	£88.92
421100	3P+N 100 Amp IP54	215(h) x 180(w) x 179(d)	£143.96
421160	3P+N 160 Amp	300(h) x 270(w) x 195(d)	£182.96
421200	3P+N 200 Amp	300(h) x 270(w) x 195(d)	£266.77
421250	3P+N 250 Amp	395(h) x 320(w) x 220(d)	£312.19
421400	3P+N 400 Amp	600(h) x 450(w) x 320(d)	£528.90
421630	3P+N 630 Amp	600(h) x 450(w) x 320(d)	£670.58
421800	3P+N 800 Amp	750(h) x 550(w) x 410(d)	£872.48

LOAD BREAK ISOLATORS METAL IP55* - 4 POLE

IES PART NO.	DESCRIPTION	DIMENSIONS	TRADE
422020	4P 20 Amp IP54	215(h) x 180(w) x 179(d)	£114.19
422032	4P 32 Amp IP54	215(h) x 180(w) x 179(d)	£118.55
422063	4P 63 Amp IP54	215(h) x 180(w) x 179(d)	£141.20
422100	4P 100 Amp IP54	215(h) x 180(w) x 179(d)	£193.93
422160	4P 160 Amp	300(h) x 270(w) x 195(d)	£310.93
422200	4P 200 Amp	300(h) x 270(w) x 195(d)	£373.01
422250	4P 250 Amp	395(h) x 320(w) x 220(d)	£530.60
422400	4P 400 Amp	600(h) x 450(w) x 320(d)	£857.97
422630	4P 630 Amp	600(h) x 450(w) x 320(d)	£1,100.03

* All units IP55 rated unless otherwise indicated

EXTENSION BOXES - FOR USE WITH ISOLATORS

IES PART NO.	SUITABLE FOR	DIMENSIONS	TRADE
EX03	250A	275(h) x 320(w) x 175(d)	£132.41
EX04	400, 630A	275(h) x 450(w) x 275(d)	£162.46
EX05	800A	275(h) x 550(w) x 300(d)	£201.45

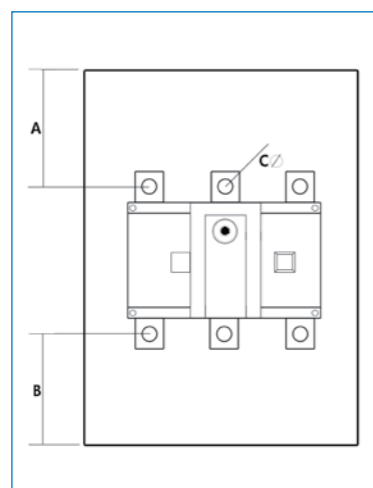

ISOLATOR INTERNAL DIMENSIONS

IES PART NO.	A	B	C
421020	70.5	70.5	-
421032	70.5	70.5	-
421063	60.5	60.5	-
421100	60.5	60.5	-
421160	108	108	8.5
421200	108	108	8.5
421250	155.5	155.5	8.5
421400	197.5	197.5	11
421630	190	190	13

COMBINATION SWITCHFUSES METAL IP55* - 3 POLE & NEUTRAL

IES PART NO.	DESCRIPTION	DIMENSIONS	TRADE
425020	3P+N 20 Amp IP54	215(h) x 180(w) x 179(d)	£100.23
425032	3P+N 32 Amp IP54	215(h) x 180(w) x 179(d)	£112.03
425063	3P+N 63 Amp	300(h) x 270(w) x 194(d)	£146.87
425100	3P+N 100 Amp	395(h) x 320(w) x 220(d)	£256.21
425160	3P+N 160 Amp	395(h) x 320(w) x 220(d)	£373.41
425200	3P+N 200 Amp	395(h) x 320(w) x 220(d)	£462.56
425250	3P+N 250 Amp	600(h) x 450(w) x 320(d)	£753.45
425400	3P+N 400 Amp	600(h) x 450(w) x 320(d)	£882.18
425630	3P+N 630 Amp	750(h) x 550(w) x 411(d)	£1,439.89

COMBINATION SWITCHFUSES METAL IP55* - 4 POLE

IES PART NO.	DESCRIPTION	DIMENSIONS	TRADE
426020	4P 20 Amp IP54	215(h) x 180(w) x 179(d)	£198.37
426032	4P 32 Amp IP54	215(h) x 180(w) x 179(d)	£208.27
426063	4P 63 Amp	300(h) x 270(w) x 194(d)	£326.17
426100	4P 100 Amp	395(h) x 320(w) x 220(d)	£503.41
426160	4P 160 Amp	395(h) x 320(w) x 220(d)	£648.15
426200	4P 200 Amp	395(h) x 320(w) x 220(d)	£832.38
426250	4P 250 Amp	600(h) x 450(w) x 320(d)	£1,345.63
426400	4P 400 Amp	600(h) x 450(w) x 320(d)	£1,574.30
426630	4P 630 Amp	750(h) x 550(w) x 411(d)	£2,645.88

* All units IP55 rated unless otherwise indicated

EXTENSION BOXES - FOR USE WITH SWITCHFUSES

IES PART NO.	SUITABLE FOR	DIMENSIONS	TRADE
EX03	100, 160, 200A	275(h) x 320(w) x 175(d)	£132.41
EX04	250, 400A	275(h) x 450(w) x 275(d)	£162.46
EX05	630A	275(h) x 550(w) x 300(d)	£201.45

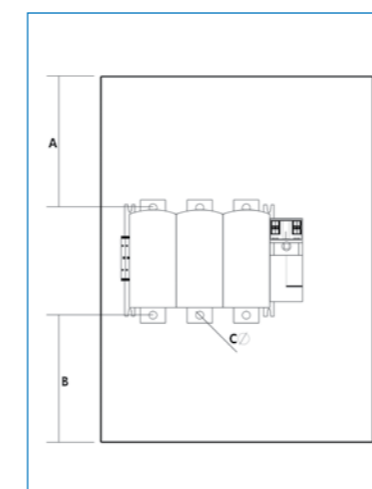

SWITCHFUSE INTERNAL DIMENSIONS

IES PART NO.	A	B	C
425020	58.5	58.5	-
425032	58.5	58.5	-
425063	97	97	-
425100	127	127	8.5
425160	127	127	8.5
425200	127	127	8.5
425250	217	217	11
425400	214	214	11
425630	245	245	13

Isolator characteristics

PRODUCT CODE	421020	421032	421063	421100	421160	421200	421250	421400	421630	421800
Thermal current I_{th} (40 °C)	20 A	32 A	63 A	100 A	160 A	200 A	250 A	400 A	630A	800 A
Rated insulation voltage U_i (V)	800	800	800	800	800	800	800	1000	1000	1000
Rated impulse withstand U_{imp} (kV)	8	8	8	8	8	8	8	12	12	12

Rated operation currents I_e (A)

Rated voltage	Load duty cat.	A	A	A	A	A/B	A/B	A/B	A/B	A/B	A/B *
400 VAC	AC-21	20/20	32/32	63/63	100/100	160/160	200/200	250/250	400/400	630/630	800/800
400 VAC	AC-22	20/20	32/32	63/63	100/100	160/160	200/200	250/250	400/400	630/630	800/800
400 VAC	AC-23	20/20	32/32	63/63	80/80	160/160	200/200	250/250	400/400	500/630	800/800
500 VAC	AC-21	20/20	32/32	63/63	100//100	160/160	200/200	250/250	400/400	630/630	800/800
500 VAC	AC-22	20/20	32/32	63/63	100/100	160/160	200/200	250/250	400/400	500/500	800/800
500 VAC	AC-23	20/20	25/25	63/63	80/80	160/160	200/200	200/250	315/315	315/315	630/800
690 VAC	AC-20	-	-	-	-	160/160	200/200	250/250	400/400	630/630	800/800
690 VAC	AC-21	20/20	32/32	63/63	100/100	160/160	200/200	200/250	400/400	500/500	800/800
690 VAC	AC-22	20/20	32/32	40/63	80/100	160/160	160/160	125/160	250/315	315/315	800/800
690 VAC	AC-23	20/20	25/25	40/40	63/63	63/80	63/80	100/125	160/200	160/200	200/250

Operational power without pre-break

at 400 VAC - AC in AC-23 A (kW)	9	15	30	40	80/80	100/100	132/132	220/220	280/280	450/450
at 500 VAC - AC in AC-23 A (kW)	9	15	30	40	110/110	140/140	140/160	220/220	220/220	450/560
at 690 VAC - AC in AC-23 A (kW)	11	15	30	45	55/75	55/75	90/110	150/185	150/185	185/220

Fuse protected short-circuit withstand (kA rms prospective)

Short circuit current (kA rms)	50	50	50	50	50	50	50	100	70	50
Associated fuse rating (A)	20	32	63	100	160	160	250	400	630	800

Overload capacity

Short-time withstand 1s I (A rms)	2500	2500	3000	3000	4000	4000	9000	13000	13000	26000
Short-circuit making capacity (kA peak)	6	6	9	9	16	16	30	45	45	55

Connection & Mechanical Characteristics

Minimum Cu cable section (mm ²)	1.5	1.5	2.5	2.5	10	10	95	185	2 x 150	2 x 185
Maximum Cu cable section (mm ²)	16	16	50	35	95	95	150	240	2 x 300	2 x 300
Minimum tightening torque (Nm)	2	2	4	4	9	9	20	20	-	-
Endurance (no. operating cycles)	100000	100000	30000	100000	10000	10000	10000	5000	5000	3000
Stud Size	-	-	-	-	M8	M8	M10	M10	M12	M14
Extension Box	-	-	-	-	-	-	EX03	EX04	EX04	EX05

* A = FREQUENT OPERATION B = INFREQUENT OPERATION

Switchfuse characteristics

PRODUCT CODE	425020	425032	425063	425100	425160	425200	425250	425400	425630
Thermal current I_{th} (40 °C)	20A	32A	63A	100A	160A	200A	250A	400A	630A
BS88/DIN fuse size	A1/-	A1/14x51	A2-A3/00C	A4/22x58	A3-A4/-	A3-A4/-	B1-B2-B3/1	B1-B2-B3-B4/2	C1-C2/3
Fuse Type (Bussman)	NITD	NITD	BAO	CEO	DEO	DEO	ED	ED	FF
Rated insulation voltage U_i (V)	800	800	750	750	750	800	750	800	1000
Rated impulse withstand U_{imp} (kV)	8	8	8	8	8	8	8	8	12

Rated operation currents I_e (A)

Rated voltage	Load duty cat.	A/B	A/B	A/B	A/B	A/B	A/B	A/B	A/B	A/B *
400 VAC	AC-22	20/20	32/32	63/63	100/100	160/160	200/200	250/250	400/400	630/630
400 VAC	AC-23	20/20	32/32	63/63	100/100	160/160	200/200	250/250	400/400	630/630
690 VAC	AC-22	20/20	32/32	63/63	*100/100	*160/160	*160/160	*250/250	315/400	500/630
690 VAC	AC-23	20/20	32/32	63/63	*100/100	*125/125	*125/125	*250/250	250/315	315/400
220 VDC	DC-22			63/63	100/100	160/160	160/160	250/250	315/315	315/630
220 VDC	DC-23			40/40	100/100	125/125	125/125	200/200	200/315	400/630
400 VDC	DC-22			*63/63	*100/100	*160/160	*160/160	*250/250	*315/315	*315/630
400 VDC	DC-23			*40/40	*100/100	*160/160	*125/125	*200/200	*250/315	*400/630

2 poles in series by polarity *Shrouded + Poles cannot be juxtaposed

Operational power without pre-break

at 400 VAC - AC in AC-3 (kW)	9/9	15/15	30/30	51/51	80/80	80/80	132/132	220/220	355/355
at 690 VAC - AC in AC-3 (kW)	15/15	25/25	55/55	90/90	110/110	110/110	220/220	220/295	295/400

Fuse protected short-circuit withstand (kA rms prospective)

Short circuit current (kA rms)	80/-	80/100	80/100	80/100	50/-	50/-	80/100	80/50	80/100
Associated fuse rating (A)	20/-	32/32	63/63	100/100	160/-	200/-	250/250	400/400	630/630

Overload capacity

Short-circuit making capacity (kA peak)	5.5	5.5	10.6	20	20	20	32.5	40	70
---	-----	-----	------	----	----	----	------	----	----

Connection & Mechanical Characteristics

Minimum Cu cable section (mm ²)	2.5	2.5	10	25	35	50	95	185	2 x 150
Maximum Cu cable section (mm ²)	16	16	25	95	95	95	240	240	2 x 300
Minimum tightening torque (Nm)	2	2	6	9	9	9	20	20	4
Stud Size	-	-	-	M8	M8	M8	M10	M10	M12
Extension Box	-	-	-	EX03	EX03	EX03	EX04	EX04	EX05

* A = FREQUENT OPERATION B = INFREQUENT OPERATION

LOAD BREAK ISOLATORS GRP IP65 - 3 POLE & NEUTRAL

IES PART NO.	DESCRIPTION	DIMENSIONS	TRADE
42102GRP	3P+N 20 Amp	300(h) x 250(w) x 184(d)	POA
421032GRP	3P+N 32 Amp	300(h) x 250(w) x 184(d)	POA
421063GRP	3P+N 63 Amp	300(h) x 250(w) x 184(d)	POA
421100GRP	3P+N 100 Amp	300(h) x 250(w) x 184(d)	POA
421160GRP	3P+N 160 Amp	400(h) x 300(w) x 245(d)	POA
421200GRP	3P+N 200 Amp	400(h) x 300(w) x 245(d)	POA
421250GRP	3P+N 250 Amp	400(h) x 400(w) x 245(d)	POA
421400GRP	3P+N 400 Amp	600(h) x 500(w) x 275(d)	POA
421630GRP	3P+N 630 Amp	600(h) x 500(w) x 275(d)	POA

COMBINATION SWITCHFUSE GRP IP65 - 3 POLE & NEUTRAL

IES PART NO.	DESCRIPTION	DIMENSIONS	TRADE
42502GRP	3P+N 20 Amp	300(h) x 250(w) x 184(d)	POA
425032GRP	3P+N 32 Amp	300(h) x 250(w) x 184(d)	POA
425063GRP	3P+N 63 Amp	400(h) x 300(w) x 245(d)	POA
425100GRP	3P+N 100 Amp	215(h) x 180(w) x 179(d)	POA
425160GRP	3P+N 160 Amp	400(h) x 400(w) x 245(d)	POA
425200GRP	3P+N 200 Amp	400(h) x 400(w) x 245(d)	POA
425250GRP	3P+N 250 Amp	600(h) x 500(w) x 275(d)	POA
425400GRP	3P+N 400 Amp	600(h) x 500(w) x 275(d)	POA
425630GRP	3P+N 630 Amp	800(h) x 600(w) x 345(d)	POA

IP65 ROTARY ISOLATORS

AMPS	IES PART NO.	DESCRIPTION	TRADE
16	GIS316	16 Amp 3 pole	£20.95
	GIS416	16 Amp 4 pole	£24.89
20	GIS320	20 Amp 3 pole	£23.58
	GIS420	20 Amp 4 pole	£27.07
25	GIS325	25 Amp 3 pole	£26.22
	GIS425	25 Amp 4 pole	£29.70
32	GIS332	32 Amp 3 pole	£32.94
	GIS432	32 Amp 4 pole	£36.42

4 POLE IP65 CHANGEOVER SWITCHES

IES PART NO.	DESCRIPTION	RATING	TRADE
GOK 463	300(h) x 300(w) x 208(d)	63A	POA
GOK 4100	300(h) x 300(w) x 208(d)	100A	POA
GOK 4125	500(h) x 400(w) x 308(d)	125A	POA
GOK 4160	500(h) x 400(w) x 308(d)	160A	POA
GOK 4250	500(h) x 400(w) x 308(d)	250A	POA
GOK 4400	800(h) x 600(w) x 358(d)	400A	POA
GOK 4630	800(h) x 600(w) x 358(d)	630A	POA
GOK 4800	1200(h) x 700(w) x 574(d)	800	POA

Bridging bars available on request

CHANGEOVER INTERNAL DIMENSIONS

IES PART NO.	A	B	C
GOK 463	105.5	105.5	-
GOK 4100	105.5	105.5	-
GOK 4125	190	190	8.5
GOK 4160	190	190	8.5
GOK 4250	185	185	8.5
GOK 4400	330	330	8.5
GOK 4630	290	290	8.5
GOK 4800	465	465	11

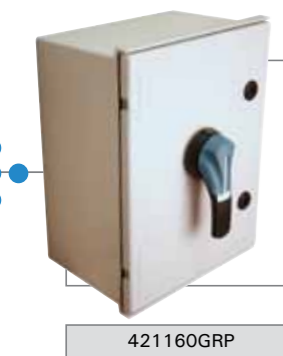
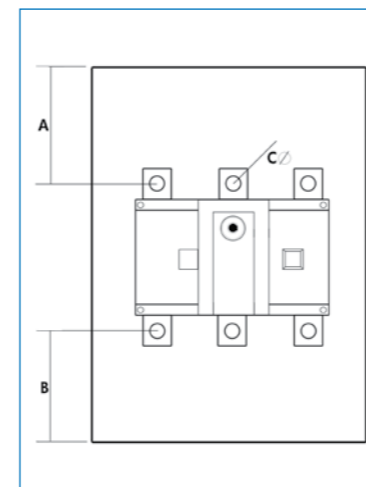

421160GRP



GOK 463

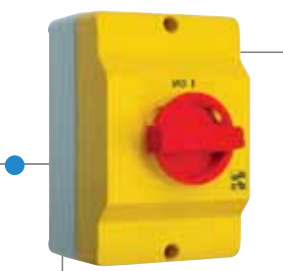

GIS316

LOAD BREAK ISOLATORS

IES PART NO.	DESCRIPTION	TRADE
2600 3014	3P 125 Amp	£129.09
2600 3017	3P 160 Amp	£224.58
2600 3021	3P 200 Amp	£234.65
2600 3026	3P 250 Amp	£279.14
2600 3032	3P 315 Amp	£333.69
2600 3041	3P 400 Amp	£373.83
2600 3051	3P 500 Amp	£423.40
2600 3064	3P 630 Amp	£711.56
2600 3081	3P 800 Amp	£851.48
2600 4014	4P 125 Amp	£151.93
2600 4017	4P 160 Amp	£250.07
2600 4021	4P 200 Amp	£266.62
2600 4026	4P 250 Amp	£322.83
2600 4032	4P 315 Amp	£405.23
2600 4041	4P 400 Amp	£447.62
2600 4051	4P 500 Amp	£568.85
2600 4064	4P 630 Amp	£833.49
2600 4081	4P 800 Amp	£964.90



2600 4081

COMBINATION SWITCH FUSES

IES PART NO.	DESCRIPTION	TRADE
3841 3003	3P 32 Amp	£62.83
3841 3006	3P 63 Amp	£110.11
3841 3010	3P 100 Amp	£171.36
3841 3015	3P 160 Amp	£264.60
3841 3021	3P 200 Amp	£344.11
3841 3024	3P 250 Amp	£473.75
3841 3032	3P 315 Amp	£562.15
3841 3039	3P 400 Amp	£735.77
3821 3063	3P 630 Amp	£1,254.15
3821 3080	3P 800 Amp	£1,531.60
3841 6003	4P 32 Amp	£91.22
3841 6006	4P 63 Amp	£152.45
3841 6010	4P 100 Amp	£245.15
3841 6015	4P 160 Amp	£348.23
3841 6021	4P 200 Amp	£472.50
3841 6024	4P 250 Amp	£731.21
3841 6032	4P 315 Amp	£839.21
3841 6039	4P 400 Amp	£998.79
3821 6063	4P 630 Amp	£1,443.69
3821 6080	4P 800 Amp	£1,697.28



3841 3010

EXTERNAL HANDLES & SHAFT EXTENSIONS

IES PART NO.	DESCRIPTION	RATING	TRADE
1421 2111	Black door interlocked handle	125...630	£30.56
1424 2111	Red / Yellow door interlocked handle	125...630	£41.24
1443 3111	Black door interlocked handle	800...1600	£117.02
1444 3111	Red / Yellow door interlocked handle	800...1600	£126.70
1400 1020	200mm Shaft extension	125...630	£14.20
1400 1032	320mm Shaft extension	125...630	£21.85
1401 1520	200mm Shaft extension	800...1600	£31.07
1401 1532	320mm Shaft extension	800...1600	£36.58

Direct operation handles also available on request

TERMINAL SHROUDS

IES PART NO.	DESCRIPTION	RATING	TRADE
2694 3014	3 Pole terminal shroud	125...160	£23.13
2694 4014	4 Pole terminal shroud	125...160	£24.76
2694 3021	3 Pole terminal shroud	200...250	£44.18
2694 4021	4 Pole terminal shroud	200...250	£45.83
2694 3051	3 Pole terminal shroud	315...630	£45.83
2694 4051	4 Pole terminal shroud	315...630	£47.44

Auxiliary contacts are available on request



1443 3111

EXTERNAL HANDLES & SHAFT EXTENSIONS

IES PART NO.	DESCRIPTION	RATING	TRADE
1411 2111	Black door interlocked handle	32...63	£25.45
1414 2111	Red / Yellow door interlocked handle	32...63	£29.48
1421 2111	Black door interlocked handle	100...400	£30.56
1424 2111	Red / Yellow door interlocked handle	100...400	£41.24
1433 3111	Black door interlocked handle	630...800	£90.31
1434 3111	Red / Yellow door interlocked handle	630...800	£113.80
1400 1020	200mm Shaft extension	32...400	£14.20
1400 1032	320mm Shaft extension	32...400	£21.85
1400 1220	200mm Shaft extension	630...800	£19.38
1400 1232	320mm Shaft extension	630...800	£33.64

Direct operation handles also available on request

TERMINAL SHROUDS

IES PART NO.	DESCRIPTION	RATING	TRADE
3998 3016	Top / bottom terminal shroud	100...160	£13.11
3998 4016	Top / bottom terminal shroud	100...160	£14.54
3998 3025	Top / bottom terminal shroud	200...400	£18.15
3998 4025	Top / bottom terminal shroud	200...400	£21.05
3898 3080	Top / bottom terminal shroud	630...800	£50.97
3898 4080	Top / bottom terminal shroud	630...800	£65.44

Auxiliary contacts are available on request



3998 3016

IP66 ENCLOSURES

IES PART NO.	DIMENSIONS	TRADE
GN252515	250x250x150	£62.34
GN302015	300x200x150	£61.63
GN302515	300x250x150	£64.53
GN303015	300x300x150	£67.57
GN303020	300x300x200	£72.34
GN403015	400x300x150	£73.64
GN403020	400x300x200	£79.08
GN404020	400x400x200	£86.88
GN503015	500x300x150	£83.47
GN503020	500x300x200	£89.44
GN504015	500x400x150	£97.78
GN504020	500x400x200	£103.98
GN504025	500x400x250	£111.51
GN505015	500x500x150	£105.62
GN505020	500x500x200	£113.90
GN505025	500x500x250	£117.13
GN505030	500x500x300	£127.82
GN604020	600x400x200	£113.31
GN604025	600x400x250	£120.55
GN604030	600x400x300	£127.58
GN605020	600x500x200	£124.56
GN605025	600x500x250	£132.31
GN605030	600x500x300	£139.89
GN606020	600x600x200	£138.31
GN606025	600x600x250	£146.94
GN705015	700x500x150	£201.21
GN705020	700x500x200	£208.84
GN705025	700x500x250	£217.47
GN806020	800x600x200	£245.88
GN806025	800x600x250	£255.48
GN806030	800x600x300	£263.57
GN808025	800x800x250	£289.26
GN808030	800x800x300	£297.38
GN1006025	1000x600x250	£312.44
GN1006030	1000x600x300	£306.64
GN1008030	1000x800x300	£354.69
GN1206030	1200x600x300	£353.27
GN1208030	1200x800x300	£399.30
GN12010030	1200x1000x300	£443.92

Price above includes metal mounting plate



GN252515



GN403020



GN604020

ACCESSORIES FOR METAL CABINETS

IES PART NO.	MODULES	ROWS	ENCL DIMENSIONS	TRADE
CH3025	16	2	300X250	£64.35
CH4030	33	3	400X300	£68.85
CH5040	48	3	500X400	£75.60
CH6040	64	4	600X400	£80.50
CH7050	110	5	700X500	£89.75
CH8060	128	4X26-1X24	800X600	£98.60



CH6040

LOCKS

IES PART NO.	DESCRIPTION	TRADE
48450	2 pin replacement lock	£4.75
48451	Triangle lock	£4.75
48455	Square lock	£4.75
48456	1/4 turn lock with key	£6.50
48457	1/4 turn lock with key and wingnut	£8.50



48456

KEYS

IES PART NO.	DESCRIPTION	TRADE
48449	2 pin replacement lock	£1.95
48460	2 pin replacement lock - metal	£3.50

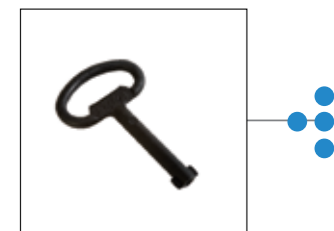

48460

IP66 GRP ENCLOSURES

IES PART NO.	DESCRIPTION	TRADE
POL302514	Enclosure 300x250x140	£65.19
PML3025	Metal Back Plate 300x250	£13.42
POL403020	Enclosure 400x300x200	£85.00
PML4030	Metal Back Plate 400x300	£15.51
POL404020	Enclosure 400x400x200	£95.98
PML4040	Metal Back Plate 400x400	£23.32
POL504020	Enclosure 500x400x200	£119.72
PML5040	Metal Back Plate 500x400	£25.20
POL604023	Enclosure 600x400x230	£136.27
PML6040	Metal Back Plate 600x400	£34.50
POL605023	Enclosure 600x500x230	£149.76
PML6050	Metal Back Plate 600x500	£38.73
POL806030	Enclosure 800x600x300	£245.39
PML8060	Metal Back Plate 800x600	£49.70

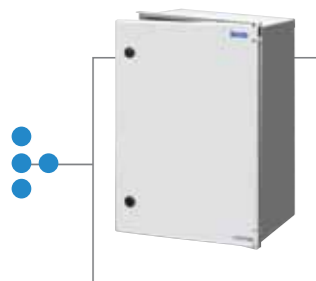

POL604023

IP67 EMPTY PLASTIC ENCLOSURES

IES PART NO.	DESCRIPTION	TRADE
EL111	108x108x64	£2.42
EL161	162x116x76	£4.88
EL231	241x180x95	£8.33
EL322	328x239x129	£22.20
GSL171	175x151x155	£10.68
GSL231	241x180x175	£15.73
GSL322	328x239x188	£24.20

IP55 DIN RAIL ENCLOSURES FOR SOCKETS

IES PART NO.	DESCRIPTION	TRADE
CS4PT	330x138x110 c/w 4 module din rail	£26.24
CS6PT	400x176x110 c/w 6 module din rail	£30.86
CS9PT	400x224x110 c/w 8 module din rail	£37.24
CS13PT	400x295x148 c/w 12 module din rail	£54.41
CS26PT	550x295x148 c/w 2x12 module din rails	£75.95



CS6PT

IP67 DIN RAIL ENCLOSURES FOR SOCKETS

IES PART NO.	DESCRIPTION	TRADE
ENCL17/8/P	284x222x122 c/w 9 module din rail	£31.62
ENCL17/8/M	369x222x130 c/w 9 module din rail	£37.76
ENCL17/12/GM	504x297x177 c/w 13 module din rail	£69.82
ENCL17/24/GM	504x297x177 c/w 2x13 module din rails	£78.33



ENCL17/24/GM

IP55 GARAGE / SHOWER UNITS

IES PART NO.	DESCRIPTION	DIMENSIONS	TRADE
NCUT4RCD40MCB2	4 mod c/w RCD, 2xMCB's	205(h) x 138(w) x 109(d)	£70.66
CT3G-RCDO40	3 mod c/w 40A RCDO	174(h) x 84(w) x 111(d)	£53.05

IP55 CONSUMER UNITS - EMPTY

IES PART NO.	DESCRIPTION	DIMENSIONS	TRADE
CD4PT/RR	4 mod c/w e&n bars	205(h) x 138(w) x 109(d)	£24.97
CD6PT/RR	6 mod c/w e&n bars	205(h) x 175(w) x 110(d)	£26.81
CD9PT/RR	9 mod c/w e&n bars	205(h) x 225(w) x 110(d)	£28.38
CD13PT/RR	12 mod c/w e&n bars	205(h) x 295(w) x 116(d)	£33.94
CD26PT/RR	24 mod (2 rows) c/w e&n bars	399(h) x 295(w) x 145(d)	£53.56
CD39PT/RR	36 mod (3 rows) c/w e&n bars	550(h) x 295(w) x 146(d)	£73.97

IP55 CONSUMER UNITS - C/W 100A MAINSWITCH

IES PART NO.	DESCRIPTION	DIMENSIONS	TRADE
CD4PTMS	2 Way	205(h) x 138(w) x 109(d)	£64.18
CD6PTMS	4 Way	205(h) x 175(w) x 110(d)	£65.92
CD9PTMS	7 Way	205(h) x 225(w) x 110(d)	£67.44
CD13PTMS	11 Way	205(h) x 295(w) x 116(d)	£73.16
CD26PTMS	24 Way (2 rows)	399(h) x 295(w) x 145(d)	£88.77
CD39PTMS	36 Way (3 rows)	550(h) x 295(w) x 146(d)	£103.44

IP55 CONSUMER UNITS - C/W 63A 30mA RCD

IES PART NO.	DESCRIPTION	DIMENSIONS	TRADE
CD6PTRCD63	4 Way	205(h) x 175(w) x 110(d)	£83.66
CD9PTRCD63	7 Way	205(h) x 225(w) x 110(d)	£86.97
CD13PTRCD63	11 Way	205(h) x 295(w) x 116(d)	£91.95
CD26PTRCD63	24 Way (2 rows)	399(h) x 295(w) x 145(d)	£109.87

RCD Enclosures

INSULATED

PROTECTION	IES PART NO.	DESCRIPTION	TRADE
IP40	CT2	130(h) x 50(w) x 64(d)	£2.64
	CT4	130(h) x 85(w) x 64(d)	£3.73
IP55	CT3G	174(h) x 84(w) x 111(d)	£12.99
	CT4G	174(h) x 101(w) x 111(d)	£16.58

2 POLE RCDs

IES PART NO.	DESCRIPTION	TRADE
RCD-25/2/030	25 Amp 2p 30mA	£36.40
RCD-40/2/030	40 Amp 2p 30mA	£36.40
RCD-63/2/030	63 Amp 2p 30mA	£47.11
RCD-80/2/030	80 Amp 2p 30mA	£68.52

RCD-25/2/100	25 Amp 2p 100mA	£46.39
RCD-40/2/100	40 Amp 2p 100mA	£46.39
RCD-63/2/100	63 Amp 2p 100mA	£57.10
RCD-80/2/100	80 Amp 2p 100mA	£68.52

4 POLE RCDs

IES PART NO.	DESCRIPTION	TRADE
RCD-25/4/030	25 Amp 4p 30mA	£58.53
RCD-40/4/030	40 Amp 4p 30mA	£58.53
RCD-63/4/030	63 Amp 4p 30mA	£69.95

RCD-25/4/100	25 Amp 4p 100mA	£69.09
RCD-40/4/100	40 Amp 4p 100mA	£69.09
RCD-63/4/100	63 Amp 4p 100mA	£76.94

2 POLE RCBO (RCD/MCB COMBI)

IES PART NO.	DESCRIPTION	TRADE
RCBO-06/2/030	6 Amp 2p 30mA	£49.89
RCBO-10/2/030	10 Amp 2p 30mA	£49.89
RCBO-16/2/030	16 Amp 2p 30mA	£49.89
RCBO-20/2/030	20 Amp 2p 30mA	£49.89
RCBO-25/2/030	25 Amp 2p 30mA	£49.89
RCBO-32/2/030	32 Amp 2p 30mA	£49.89
RCBO-40/2/030	40 Amp 2p 30mA	£49.89

Other tripping characteristics available



GARAGE UNIT



SHOWER UNIT



CDP6T/RR



CT3G



RCD-040/2/030



RCD-040/4/030



RCBO-10/2/030

SINGLE POLE MCBs

CURVE	IES PART NO.	DESCRIPTION	TRADE
B	MCBB106	6 Amp single pole	£7.49
	MCBB110	10 Amp single pole	£7.49
	MCBB116	16 Amp single pole	£7.49
	MCBB120	20 Amp single pole	£7.49
	MCBB125	25 Amp single pole	£7.49
	MCBB132	32 Amp single pole	£7.49
	MCBB140	40 Amp single pole	£7.49
	MCBB150	50 Amp single pole	£13.50
	MCBB163	63 Amp single pole	£15.55

CURVE	IES PART NO.	DESCRIPTION	TRADE
C	MCBC106	6 Amp single pole	£7.49
	MCBC110	10 Amp single pole	£7.49
	MCBC116	16 Amp single pole	£7.49
	MCBC120	20 Amp single pole	£7.49
	MCBC125	25 Amp single pole	£7.49
	MCBC132	32 Amp single pole	£7.49
	MCBC140	40 Amp single pole	£7.49
	MCBC150	50 Amp single pole	£13.50
	MCBC163	63 Amp single pole	£15.55

CURVE	IES PART NO.	DESCRIPTION	TRADE
D	MCBD106	6 Amp single pole	£12.64
	MCBD110	10 Amp single pole	£12.64
	MCBD116	16 Amp single pole	£12.64
	MCBD120	20 Amp single pole	£12.64
	MCBD125	25 Amp single pole	£12.64
	MCBD132	32 Amp single pole	£12.64
	MCBD140	40 Amp single pole	£12.64
	MCBD150	50 Amp single pole	£17.83
	MCBD163	63 Amp single pole	£19.74

DOUBLE POLE MCBs

CURVE	IES PART NO.	DESCRIPTION	TRADE
C	MCBC206	6 Amp double pole	£16.77
	MCBC210	10 Amp double pole	£16.77
	MCBC216	16 Amp double pole	£16.77
	MCBC220	20 Amp double pole	£16.77
	MCBC225	25 Amp double pole	£16.77
	MCBC232	32 Amp double pole	£16.77
	MCBC240	40 Amp double pole	£16.77
	MCBC250	50 Amp double pole	£23.27
	MCBC263	63 Amp double pole	£31.18

TRIPLE POLE MCBs

CURVE	IES PART NO.	DESCRIPTION	TRADE
C	MCBC306	6 Amp triple pole	£32.83
	MCBC310	10 Amp triple pole	£32.83
	MCBC316	16 Amp triple pole	£32.83
	MCBC320	20 Amp triple pole	£32.83
	MCBC325	25 Amp triple pole	£32.83
	MCBC332	32 Amp triple pole	£32.83
	MCBC340	40 Amp triple pole	£32.83
	MCBC350	50 Amp triple pole	£41.86
	MCBC363	63 Amp triple pole	£44.00

Other tripping characteristics available

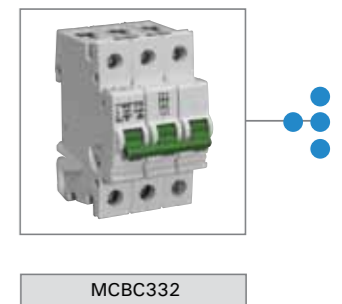
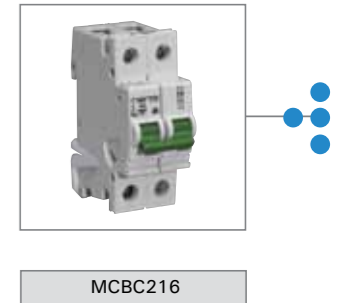
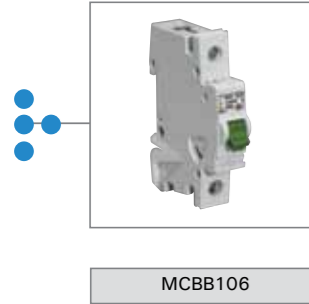

IP44 SPLASHPROOF

AMPS	VOLTS	PINS	IES PART NO.	TRADE
16	110	2P+E	P 216-4	£2.73
	240	2P+E	P 216-6	£2.73
	415	2P+E	P 216-9	£7.38
	110	3P+E	P 316-4	£7.20
	415	3P+E	P 316-6	£4.69
	240	3P+E	P 316-9	£7.23
	110	3P+N+E	P 416-4	£7.22
	415	3P+N+E	P 416-6	£5.96
32	110	2P+E	P 232-4	£6.94
	240	2P+E	P 232-6	£6.94
	415	2P+E	P 232-9	£10.61
	110	3P+E	P 332-4	£10.85
	415	3P+E	P 332-6	£7.36
	240	3P+E	P 332-9	£10.85
	110	3P+N+E	P 432-4	£11.99
	415	3P+N+E	P 432-6	£8.41
63	110	2P+E	P 263-4	£33.40
	240	2P+E	P 263-6	£33.40
	415	2P+E	P 263-9	£38.92
	110	3P+E	P 363-4	£42.09
	415	3P+E	P 363-6	£33.95
	240	3P+E	P 363-9	£42.09
	110	3P+N+E	P 463-4	£44.28
	415	3P+N+E	P 463-6	£34.77
63	110	2P+E	P 463-9	£44.28
	240	2P+E	P 263-4	£33.40
	415	2P+E	P 263-6	£33.40
	110	3P+E	P 363-4	£42.09
	415	3P+E	P 363-6	£33.95
	240	3P+E	P 363-9	£42.09
	110	3P+N+E	P 463-4	£44.28
	415	3P+N+E	P 463-6	£34.77
63	240	3P+N+E	P 463-9	£44.28

IP67 WATERTIGHT

AMPS	VOLTS	PINS	IES PART NO.	TRADE
16	110	2P+E	PV 216-4	£8.03
	240	2P+E	PV 216-6	£8.03
	415	3P+E	PV 316-6	£13.82
	415	3P+N+E	PV 416-6	£14.59
32	110	2P+E	PV 232-4	£16.45
	240	2P+E	PV 232-6	£16.45
	415	3P+E	PV 332-6	£16.78
	415	3P+N+E	PV 432-6	£17.35
63	110	2P+E	PV 263-4	£40.94
	240	2P+E	PV 263-6	£40.94
	415	3P+E	PV 363-6	£41.62
	415	3P+N+E	PV 463-6	£42.63
125	110	2P+E	PV 2125-4	£104.88
	240	2P+E	PV 2125-6	£104.88
	415	3P+E	PV 3125-6	£95.97
	415	3P+N+E	PV 4125-6	£97.10

Other configurations of BS EN 60 309 / BS 4343 are available on request.

IP44 SPLASHPROOF

AMPS	VOLTS	PINS	IES PART NO.	TRADE
16	110	2P+E	S 216-4	£4.69
	240	2P+E	S 216-6	£4.69
	415	2P+E	S 216-9	£8.49
	110	3P+E	S 316-4	£11.11
	415	3P+E	S 316-6	£6.94
	240	3P+E	S 316-9	£11.11
	110	3P+N+E	S 416-4	£11.36
	415	3P+N+E	S 416-6	£8.34
32	110	2P+E	S 232-4	£9.46
	240	2P+E	S 232-6	£9.46
	415	2P+E	S 232-9	£13.79
	110	3P+E	S 332-4	£14.33
	415	3P+E	S 332-6	£9.74
	240	3P+E	S 332-9	£14.33
	110	3P+N+E	S 432-4	£15.47
	415	3P+N+E	S 432-6	£10.30
63	110	2P+E	S 263-4	£37.52
	240	2P+E	S 263-6	£37.52
	415	2P+E	S 263-9	£45.96
	110	3P+E	S 363-4	£49.27
	415	3P+E	S 363-6	£37.62
	240	3P+E	S 363-9	£49.27
	110	3P+N+E	S 463-4	£49.58
	415	3P+N+E	S 463-6	£38.44
63	240	3P+N+E	S 463-9	£49.58

IP67 WATERTIGHT

AMPS	VOLTS	PINS	IES PART NO.	TRADE
16	110	2P+E	SV 216-4	£11.51
	240	2P+E	SV 216-6	£11.51
	415	3P+E	SV 316-6	£15.49
	415	3P+N+E	SV 416-6	£17.10
32	110	2P+E	SV 232-4	£17.48
	240	2P+E	SV 232-6	£17.48
	415	3P+E	SV 332-6	£20.50
	415	3P+N+E	SV 432-6	£21.79
63	110	2P+E	SV 263-4	£46.00
	240	2P+E	SV 263-6	£46.00
	415	3P+E	SV 363-6	£46.11
	415	3P+N+E	SV 463-6	£47.13
125	110	2P+E	SV 2125-4	£117.35
	240	2P+E	SV 2125-6	£117.35
	415	3P+E	SV 3125-6	£119.05
	415	3P+N+E	SV 4125-6	£139.14

Other configurations of BS EN 60 309 / BS 4343 are available on request.

Panel Inlets

Panel Sockets

IP44 SPLASHPROOF

AMPS	VOLTS	PINS	IES PART NO.	TRADE
16	110	2P+E	II 216-4	£6.17
	240	2P+E	II 216-6	£6.17
	415	3P+E	II 316-6	£7.22
	415	3P+N+E	II 416-6	£8.34
32	110	2P+E	II 232-4	£8.69
	240	2P+E	II 232-6	£8.69
	415	3P+E	II 332-6	£10.16
	415	3P+N+E	II 432-6	£11.56
63	110	2P+E	II 263-4	£35.45
	240	2P+E	II 263-6	£35.45
	415	3P+E	II 363-6	£42.54
	415	3P+N+E	II 463-6	£44.96



II 432-6

IP44 SPLASHPROOF STRAIGHT

AMPS	VOLTS	PINS	IES PART NO.	TRADE
16	110	2P+E	UI 216-4	£5.04
	240	2P+E	UI 216-6	£5.04
	415	2P+E	UI 216-9	£8.74
	110	3P+E	UI 316-4	£8.94
32	415	3P+E	UI 316-6	£6.31
	240	3P+E	UI 316-9	£8.94
	110	3P+N+E	UI 416-4	£13.37
	415	3P+N+E	UI 416-6	£8.06
63	240	3P+N+E	UI 416-9	£13.37
	110	2P+E	UI 232-4	£8.34
	240	2P+E	UI 232-6	£8.34
	415	2P+E	UI 232-9	£10.16
32	110	3P+E	UI 332-4	£13.52
	415	3P+E	UI 332-6	£9.74
	240	3P+E	UI 332-9	£13.52
	110	3P+N+E	UI 432-4	£13.79
63	415	3P+N+E	UI 432-6	£11.14
	240	3P+N+E	UI 432-9	£13.79
	110	2P+E	UI 263-4	£30.53
	240	2P+E	UI 263-6	£30.53
32	415	2P+E	UI 263-9	£47.66
	110	3P+E	UI 363-4	£49.28
	415	3P+E	UI 363-6	£30.69
	240	3P+E	UI 363-9	£49.28
63	110	3P+N+E	UI 463-4	£49.44
	415	3P+N+E	UI 463-6	£33.28
	240	3P+N+E	UI 463-9	£49.44



UI 232-6

SMALL FLANGE PANEL SOCKET

AMPS	VOLTS	PINS	IES PART NO.	TRADE
16	110	2P+E	UIL 216-4	£5.25
	240	2P+E	UIL 216-6	£5.25

IP67 WATERTIGHT ANGLED

AMPS	VOLTS	PINS	IES PART NO.	TRADE
16	110	2P+E	UISV 216-4	£12.54
	240	2P+E	UISV 216-6	£12.54
	415	3P+E	UISV 316-6	£14.71
	415	3P+N+E	UISV 416-6	£16.74
32	110	2P+E	UISV 232-4	£20.95
	240	2P+E	UISV 232-6	£20.95
	415	3P+E	UISV 332-6	£22.77
	415	3P+N+E	UISV 432-6	£23.75
63	110	2P+E	UISV 263-4	£35.90
	240	2P+E	UISV 263-6	£35.90
	415	3P+E	UISV 363-6	£36.10
	415	3P+N+E	UISV 463-6	£39.14
125	110	2P+E	UISV 2125-4	£132.60
	240	2P+E	UISV 2125-6	£132.60
	415	3P+E	UISV 3125-6	£103.83
	415	3P+N+E	UISV 4125-6	£103.83



UISV 232-6

Surface Inlets - Angled

Surface Sockets - Angled

IP44 SPLASHPROOF

AMPS	VOLTS	PINS	IES PART NO.	TRADE
16	110	2P+E	II 216-4 + RI	£8.44
	240	2P+E	II 216-6 + RI	£8.44
	415	3P+E	II 316-6 + RI	£9.54
	415	3P+N+E	II 416-6 + RI	£10.72
32	110	2P+E	II 232-4 + RI	£11.08
	240	2P+E	II 232-6 + RI	£11.08
	415	3P+E	II 332-6 + RI	£12.62
	415	3P+N+E	II 432-6 + RI	£14.09
63	110	2P+E	II 263-4 + RI	£48.17
	240	2P+E	II 263-6 + RI	£48.17
	415	3P+E	II 363-6 + RI	£55.97
	415	3P+N+E	II 463-6 + RI	£58.63



II 232-6 + RI

IP44 SPLASHPROOF

AMPS	VOLTS	PINS	IES PART NO.	TRADE
16	110	2P+E	UI 216-4 + RU	£6.94
	240	2P+E	UI 216-6 + RU	£6.94
	415	2P+E	UI 216-9 + RU	£10.64
	110	3P+E	UI 316-4 + RU	£10.83
	415	3P+E	UI 316-6 + RU	£8.20
	240	3P+E	UI 316-9 + RU	£10.83
32	110	3P+N+E	UI 416-4 + RU	£15.26
	415	3P+N+E	UI 416-6 + RU	£9.95
	240	3P+N+E	UI 416-9 + RU	£15.26
	110	2P+E	UI 232-4 + RU	£10.23
	240	2P+E	UI 232-6 + RU	£10.23
	415	2P+E	UI 232-9 + RU	£12.05
	110	3P+E	UI 332-4 + RU	£15.41
	415	3P+E	UI 332-6 + RU	£11.63
63	240	3P+E	UI 332-9 + RU	£15.41
	110	3P+N+E	UI 432-4 + RU	£15.68
	415	3P+N+E	UI 432-6 + RU	£13.03
	240	3P+N+E	UI 432-9 + RU	£15.68
	110	2P+E	UI 263-4 + RU	£46.24
	240	2P+E	UI 263-6 + RU	£46.24
	415	2P+E	UI 263-9 + RU	£56.68
	110	3P+E	UI 363-4 + RU	£57.91
	415	3P+E	UI 363-6 + RU	£47.25
	240	3P+E	UI 363-9 + RU	£57.91



UI 263-6 + RU

IP67 WATERTIGHT

AMPS	VOLTS	PINS	IES PART NO.	TRADE
16	110	2P+E	IIV 216-4 + RI	£23.54
	240	2P+E	IIV 216-6 + RI	£23.54
	415	3P+E	IIV 316-6 + RI	£23.96
	415	3P+N+E	IIV 416-6 + RI	£25.64
32	110	2P+E	IIV 232-4 + RI	£28.16
	240	2P+E	IIV 232-6 + RI	£28.16
	415	3P+E	IIV 332-6 + RI	£30.13
	415	3P+N+E	IIV 432-6 + RI	£38.67
63	110	2P+E	IIV 263-4 + RI	£51.49
	240	2P+E	IIV 263-6 + RI	£51.49
	415	3P+E	IIV 363-6 + RI	£59.83
	415	3P+N+E	IIV 463-6 + RI	£62.68
125	110	2P+E	IIV 2125-4 + RI	£144.55
	240	2P+E	IIV 2125-6 + RI	£144.55
	415	3P+E	IIV 3125-6 + RI	£149.82
	415	3P+N+E	IIV 4125-6 + RI	£164.45



IIV 216-6 + RI

IP67 WATERTIGHT

AMPS	VOLTS	PINS	IES PART NO.	TRADE
16	110	2P+E	UIV 216-4 + RU	£13.43
	240	2P+E	UIV 216-6 + RU	£13.43
	415	3P+E	UIV 316-6 + RU	£17.75
	415	3P+N+E	UIV 416-6 + RU	£18.22
32	110	2P+E	UIV 232-4 + RU	£21.93
	240	2P+E	UIV 232-6 + RU	£21.93
	415	3P+E	UIV 332-6 + RU	£23.28
	415	3P+N+E	UIV 432-6 + RU	£24.23
63	110	2P+E	UIV 263-4 + RU	£47.62
	240	2P+E	UIV 263-6 + RU	£47.62
	415	3P+E	UIV 363-6 + RU	£48.65
	415	3P+N+E	UIV 463-6 + RU	£51.97
125	110	2P+E	UIV 2125-4 + RU	£170.48
	240	2P+E	UIV 2125-6 + RU	£170.48
	415	3P+E	UIV 3125-6 + RU	£178.09
	415	3P+N+E	UIV 4125-6 + RU	£186.19



UIV 432-6 + RU

1 GANG SURFACE SOCKET OUTLET - IP44 SPLASHPROOF

AMPS	VOLTS	PINS	IES PART NO.	TRADE
16	110	2P+E	N 1216-4	POA
	240	2P+E	N 1216-6	POA
	415	3P+E	N 1316-6	POA
	415	3P+N+E	N 1416-6	POA
32	110	2P+E	N 1232-4	POA
	240	2P+E	N 1232-6	POA
	415	3P+E	N 1332-6	POA
	415	3P+N+E	N 1432-6	POA

2 GANG SURFACE SOCKET OUTLET - IP44 SPLASHPROOF

AMPS	VOLTS	PINS	IES PART NO.	TRADE
16	110	2P+E	N 2216-4	POA
	240	2P+E	N 2216-6	POA
	415	3P+E	N 2316-6	POA
	415	3P+N+E	N 2416-6	POA
32	110	2P+E	N 2232-4	POA
	240	2P+E	N 2232-6	POA
	415	3P+E	N 2332-6	POA
	415	3P+N+E	N 2432-6	POA

1 GANG SOCKET - IP67 WATERTIGHT

AMPS	VOLTS	PINS	IES PART NO.	TRADE
16	110	2P+E	NV 1216-4	POA
	240	2P+E	NV 1216-6	POA
	415	3P+E	NV 1316-6	POA
	415	3P+N+E	NV 1416-6	POA
32	110	2P+E	NV 1232-4	POA
	240	2P+E	NV 1232-6	POA
	415	3P+E	NV 1332-6	POA
	415	3P+N+E	NV 1432-6	POA

2 GANG SOCKET - IP67 WATERTIGHT

AMPS	VOLTS	PINS	IES PART NO.	TRADE
16	110	2P+E	NV 2216-4	POA
	240	2P+E	NV 2216-6	POA
	415	3P+E	NV 2316-6	POA
	415	3P+N+E	NV 2416-6	POA
32	110	2P+E	NV 2232-4	POA
	240	2P+E	NV 2232-6	POA
	415	3P+E	NV 2332-6	POA
	415	3P+N+E	NV 2432-6	POA

3 GANG SOCKET - IP44 SPLASHPROOF

AMPS	VOLTS	PINS	IES PART NO.	TRADE
16	110	2P+E	N 3216-4	POA
	240	2P+E	N 3216-6	POA
	415	3P+E	N 3316-6	POA
	415	3P+N+E	N 3416-6	POA
32	110	2P+E	N 3232-4	POA
	240	2P+E	N 3232-6	POA
	415	3P+E	N 3332-6	POA
	415	3P+N+E	N 3432-6	POA

4 GANG SOCKET - IP44 SPLASHPROOF

AMPS	VOLTS	PINS	IES PART NO.	TRADE
16	110	2P+E	N 4216-4	POA
	240	2P+E	N 4216-6	POA
	415	3P+E	N 4316-6	POA
	415	3P+N+E	N 4416-6	POA
32	110	2P+E	N 4232-4	POA
	240	2P+E	N 4232-6	POA
	415	3P+E	N 4332-6	POA
	415	3P+N+E	N 4432-6	POA

3 GANG SOCKET - IP67 WATERTIGHT

AMPS	VOLTS	PINS	IES PART NO.	TRADE
16	110	2P+E	NV 3216-4	POA
	240	2P+E	NV 3216-6	POA
	415	3P+E	NV 3316-6	POA
	415	3P+N+E	NV 3416-6	POA
32	110	2P+E	NV 3232-4	POA
	240	2P+E	NV 3232-6	POA
	415	3P+E	NV 3332-6	POA
	415	3P+N+E	NV 3432-6	POA

4 GANG SOCKET - IP67 WATERTIGHT

AMPS	VOLTS	PINS	IES PART NO.	TRADE
16	110	2P+E	NV 4216-4	POA
	240	2P+E	NV 4216-6	POA
	415	3P+E	NV 4316-6	POA
	415	3P+N+E	NV 4416-6	POA
32	110	2P+E	NV 4232-4	POA
	240	2P+E	NV 4232-6	POA
	415	3P+E	NV 4332-6	POA
	415	3P+N+E	NV 4432-6	POA

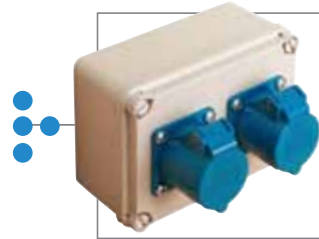

N 2216-6

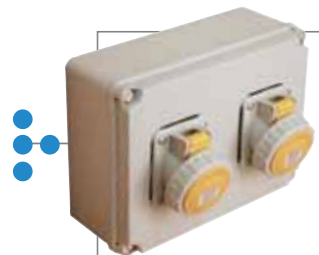

NV 2216-4



N 3216-6



NV 4416-6

RCD Protected Single Sockets

RCD Protected Double Sockets

IP44 SPLASHPROOF

AMPS	VOLTS	PINS	IES PART NO.	TRADE
16	110	2P+E	URB 216-4	£96.41
	240	2P+E	URB 216-6	£96.41
	415	3P+E	URB 316-6	£110.88
	415	3P+N+E	URB 416-6	£111.84
32	110	2P+E	URB 232-4	£115.05
	240	2P+E	URB 232-6	£115.05
	415	3P+E	URB 332-6	£121.48
	415	3P+N+E	URB 432-6	£128.23
63	110	2P+E	URB 263-4	£186.40
	240	2P+E	URB 263-6	£186.40
	415	3P+E	URB 363-6	£199.25
	415	3P+N+E	URB 463-6	£212.11



URB 432-6

IP44 SPLASHPROOF

AMPS	VOLTS	PINS	IES PART NO.	TRADE
16	110	2P+E	PR 2216-4	POA
	240	2P+E	PR 2216-6	POA
	415	3P+E	PR 2316-6	POA
	415	3P+N+E	PR 2416-6	POA
32	110	2P+E	PR 2232-4	POA
	240	2P+E	PR 2232-6	POA
	415	3P+E	PR 2332-6	POA
	415	3P+N+E	PR 2432-6	POA
63	110	2P+E	PR 2263-4	POA
	240	2P+E	PR 2263-6	POA
	415	3P+E	PR 2363-6	POA
	415	3P+N+E	PR 2463-6	POA

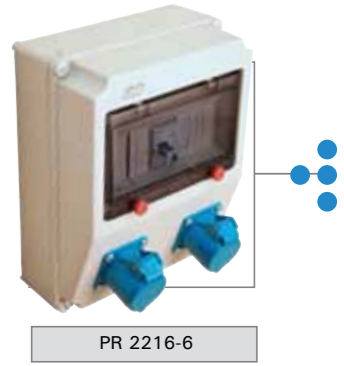

PR 2216-6

IP67 WATERTIGHT

AMPS	VOLTS	PINS	IES PART NO.	TRADE
16	110	2P+E	URBV 1216-4	£134.98
	240	2P+E	URBV 1216-6	£134.98
	415	3P+E	URBV 1316-6	£155.22
	415	3P+N+E	URBV 1416-6	£156.58
32	110	2P+E	URBV 1232-4	£161.08
	240	2P+E	URBV 1232-6	£161.08
	415	3P+E	URBV 1332-6	£170.07
	415	3P+N+E	URBV 1432-6	£179.52
63	110	2P+E	URBV 1263-4	£260.96
	240	2P+E	URBV 1263-6	£260.96
	415	3P+E	URBV 1363-6	£278.95
	415	3P+N+E	URBV 1463-6	£296.96



URBV 1216-6

IP67 WATERTIGHT

AMPS	VOLTS	PINS	IES PART NO.	TRADE
16	110	2P+E	PRV 2216-4	POA
	240	2P+E	PRV 2216-6	POA
	415	3P+E	PRV 2316-6	POA
	415	3P+N+E	PRV 2416-6	POA
32	110	2P+E	PRV 2232-4	POA
	240	2P+E	PRV 2232-6	POA
	415	3P+E	PRV 2332-6	POA
	415	3P+N+E	PRV 2432-6	POA
63	110	2P+E	PRV 2263-4	POA
	240	2P+E	PRV 2263-6	POA
	415	3P+E	PRV 2363-6	POA
	415	3P+N+E	PRV 2463-6	POA



PRV 2216-6

RCD Protected Triple Sockets

RCD Protected 4 Way Sockets



PR 3216-6

IP44 SPLASHPROOF

AMPS	VOLTS	PINS	IES PART NO.	TRADE
16	110	2P+E	PR 3216-4	POA
	240	2P+E	PR 3216-6	POA
	415	3P+E	PR 3316-6	POA
	415	3P+N+E	PR 3416-6	POA
32	110	2P+E	PR 3232-4	POA
	240	2P+E	PR 3232-6	POA
	415	3P+E	PR 3332-6	POA
	415	3P+N+E	PR 3432-6	POA
63	110	2P+E	PR 3263-4	POA
	240	2P+E	PR 3263-6	POA
	415	3P+E	PR 3363-6	POA
	415	3P+N+E	PR 3463-6	POA

IP44 SPLASHPROOF

AMPS	VOLTS	PINS	IES PART NO.	TRADE
16	110	2P+E	PR 4216-4	POA
	240	2P+E	PR 4216-6	POA
	415	3P+E	PR 4316-6	POA
	415	3P+N+E	PR 4416-6	POA
32	110	2P+E	PR 4232-4	POA
	240	2P+E	PR 4232-6	POA
	415	3P+E	PR 4332-6	POA
	415	3P+N+E	PR 4432-6	POA
63	110	2P+E	PR 4263-4	POA
	240	2P+E	PR 4263-6	POA
	415	3P+E	PR 4363-6	POA
	415	3P+N+E	PR 4463-6	POA



PR 4216-6

IP67 WATERTIGHT

AMPS	VOLTS	PINS	IES PART NO.	TRADE
16	110	2P+E	PRV 3216-4	POA
	240	2P+E	PRV 3216-6	POA
	415	3P+E	PRV 3316-6	POA
	415	3P+N+E	PRV 3416-6	POA
32	110	2P+E	PRV 3232-4	POA
	240	2P+E	PRV 3232-6	POA
	415	3P+E	PRV 3332-6	POA
	415	3P+N+E	PRV 3432-6	POA
63	110	2P+E	PRV 3263-4	POA
	240	2P+E	PRV 3263-6	POA
	415	3P+E	PRV 3363-6	POA
	415	3P+N+E	PRV 3463-6	POA

IP67 WATERTIGHT

AMPS	VOLTS	PINS	IES PART NO.	TRADE
16	110	2P+E	PRV 4216-4	POA
	240	2P+E	PRV 4216-6	POA
	415	3P+E	PRV 4316-6	POA
	415	3P+N+E	PRV 4416-6	POA
32	110	2P+E	PRV 4232-4	POA
	240	2P+E	PRV 4232-6	POA
	415	3P+E	PRV 4332-6	POA
	415	3P+N+E	PRV 4432-6	POA
63	110	2P+E	PRV 4263-4	POA
	240	2P+E	PRV 4263-6	POA
	415	3P+E	PRV 4363-6	POA
	415	3P+N+E	PRV 4463-6	POA



PRV 4216-6

IP44 SPLASHPROOF

AMPS	VOLTS	PINS	IES PART NO.	TRADE
16	110	2P+E	UB 216-4	£53.65
	240	2P+E	UB 216-6	£53.65
	415	3P+E	UB 316-6	£55.34
	415	3P+N+E	UB 416-6	£60.07
32	110	2P+E	UB 232-4	£74.17
	240	2P+E	UB 232-6	£74.17
	415	3P+E	UB 332-6	£78.22
	415	3P+N+E	UB 432-6	£80.92
63	110	2P+E	UB 263-4	£138.35
	240	2P+E	UB 263-6	£138.35
	415	3P+E	UB 363-6	£154.21
	415	3P+N+E	UB 463-6	£161.64



UB 463-6

IP44 SPLASHPROOF

AMPS	VOLTS	PINS	IES PART NO.	TRADE
16	110	2P+E	UB 216-4 + RB	£141.73
	240	2P+E	UB 216-6 + RB	£141.73
	415	3P+E	UB 316-6 + RB	£147.13
	415	3P+N+E	UB 416-6 + RB	£156.58
32	110	2P+E	UB 232-4 + RB	£166.70
	240	2P+E	UB 232-6 + RB	£166.70
	415	3P+E	UB 332-6 + RB	£185.60
	415	3P+N+E	UB 432-6 + RB	£187.62
63	110	2P+E	UB 263-4 + RB	£236.21
	240	2P+E	UB 263-6 + RB	£236.21
	415	3P+E	UB 363-6 + RB	£253.42
	415	3P+N+E	UB 463-6 + RB	£256.12



UB 416-6 + RB

IP67 WATERTIGHT

AMPS	VOLTS	PINS	IES PART NO.	TRADE
16	110	2P+E	UBV 216-4	£71.54
	240	2P+E	UBV 216-6	£71.54
	415	3P+E	UBV 316-6	£73.79
	415	3P+N+E	UBV 416-6	£80.09
32	110	2P+E	UBV 232-4	£98.89
	240	2P+E	UBV 232-6	£98.89
	415	3P+E	UBV 332-6	£104.30
	415	3P+N+E	UBV 432-6	£107.89
63	110	2P+E	UBV 263-4	£227.31
	240	2P+E	UBV 263-6	£227.31
	415	3P+E	UBV 363-6	£231.55
	415	3P+N+E	UBV 463-6	£244.28
125	110	2P+E	UBV 2125-4	£863.87
	240	2P+E	UBV 2125-6	£666.41
	415	3P+E	UBV 3125-6	£678.75
	415	3P+N+E	UBV 4125-6	£685.22



UBV 263-6

IP67 WATERTIGHT

AMPS	VOLTS	PINS	IES PART NO.	TRADE
16	110	2P+E	UBV 216-4 + RB	£179.97
	240	2P+E	UBV 216-6 + RB	£179.97
	415	3P+E	UBV 316-6 + RB	£186.83
	415	3P+N+E	UBV 416-6 + RB	£198.83
32	110	2P+E	UBV 232-4 + RB	£211.68
	240	2P+E	UBV 232-6 + RB	£211.68
	415	3P+E	UBV 332-6 + RB	£235.68
	415	3P+N+E	UBV 432-6 + RB	£238.25
63	110	2P+E	UBV 263-4 + RB	£299.95
	240	2P+E	UBV 263-6 + RB	£299.95
	415	3P+E	UBV 363-6 + RB	£338.52
	415	3P+N+E	UBV 463-6 + RB	£351.99



UBV 216-6 + RB

SINGLE EYE, SINGLE WEAVE, LIGHT DUTY

IES PART NO.	RANGE (mm)	MBS (Kg)	TRADE
LD/4	4-6	134	£13.49
LD/6	6-10	207	£13.49
LD/10	10-13	390	£16.07
LD/13	13-16	567	£17.62
LD/16	16-19	814	£27.81
LD/19	19-25	1174	£29.78
LD/25	25-32	1854	£33.05

SINGLE EYE, DOUBLE WEAVE, GENERAL DUTY

IES PART NO.	RANGE (mm)	MBS (Kg)	TRADE
106/10	10-20	1860	£40.46
106/20	20-30	2256	£45.21
106/30	30-40	3696	£45.21
106/40	40-50	5490	£47.22
106/50	50-65	5490	£47.22
106/65	65-80	7320	£51.74
106/80	80-95	7320	£59.56
106/95	95-110	10613	£85.90

DOUBLE EYE, DOUBLE WEAVE, GENERAL DUTY

IES PART NO.	RANGE (mm)	MBS (Kg)	TRADE
206/10	10-20	1860	£46.31
206/20	20-30	2256	£48.75
206/30	30-40	3696	£52.17
206/40	40-50	5490	£54.79
206/50	50-65	5490	£57.78
206/65	65-80	7320	£63.06
206/80	80-95	7320	£74.39
206/95	95-110	10613	£103.07

SINGLE OFFSET EYE, DOUBLE WEAVE, GENERAL DUTY

IES PART NO.	RANGE (mm)	MBS (Kg)	TRADE
306/10	10-20	1860	£42.82
306/20	20-30	2256	£51.06
306/30	30-40	3696	£56.30
306/40	40-50	5490	£61.09
306/50	50-65	5490	£70.44
306/65	65-80	7320	£81.95
306/80	80-95	7320	£94.14
306/95	95-110	10613	£108.27

DOUBLE EYE, LACE UP, DOUBLE WEAVE, GENERAL DUTY

IES PART NO.	RANGE (mm)	MBS (Kg)	TRADE
406/10	10-20	1860	£46.31
406/20	20-30	2256	£52.17
406/30	30-40	3696	£56.98
406/40	40-50	5490	£61.97
406/50	50-65	5490	£65.88
406/65	65-80	7320	£77.61
406/80	80-95	7320	£83.69
406/95	95-110	10613	£108.51



106/40

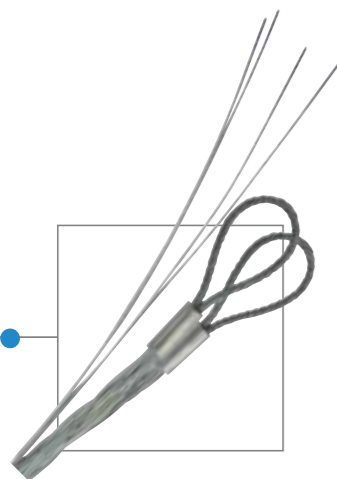

460/50

SINGLE EYE, SINGLE WEAVE

IES PART NO.	RANGE (mm)	MBS (Kg)	TRADE
LS1/4	4-6	135	£14.14
LS1/6	6-8	207	£14.14
LS1/8	8-10	346	£15.00
LS1/10	10-13	346	£15.64
LS1/13	13-16	346	£16.72
LS1/16	16-20	681	£19.18
LS1/20	20-25	814	£20.22

DOUBLE EYE, SINGLE WEAVE

IES PART NO.	RANGE (mm)	MBS (Kg)	TRADE
LS2/10	10-13	346	£20.22
LS2/13	13-17	346	£22.19
LS2/16	16-21	681	£24.81
LS2/20	20-25	814	£26.97
LS2/25	25-30	1173	£31.54
LS2/30	30-38	1173	£32.64

SINGLE OFFSET EYE, SINGLE WEAVE

IES PART NO.	RANGE (mm)	MBS (Kg)	TRADE
LS3/10	10-13	346	£18.05
LS3/13	13-17	346	£23.62
LS3/16	16-21	681	£21.31
LS3/20	20-25	814	£23.48
LS3/25	25-30	1173	£24.35
LS3/30	30-38	1173	£25.23

SINGLE EYE, LACE UP, SINGLE WEAVE

IES PART NO.	RANGE (mm)	MBS (Kg)	TRADE
LSL1/10	10-17	346	£18.93
LSL1/16	16-20	681	£22.37
LSL1/20	20-25	814	£28.13
LSL1/25	25-32	1173	£25.83
LSL1/30	30-38	1173	£26.79

DOUBLE EYE, LACE UP, SINGLE WEAVE

IES PART NO.	RANGE (mm)	MBS (Kg)	TRADE
LSL2/10	10-17	346	£23.52
LSL2/16	16-20	681	£28.08
LSL2/20	20-25	814	£30.21
LSL2/25	25-32	1173	£34.85
LSL2/30	30-38	1173	£35.86

THREADED ANCHOR GRIPS

IES PART NO.	RANGE (mm)	MBS (Kg)	TRADE
TAG6 M20	6-10	160	£18.24
TAG6 M25	6-10	160	£19.34
TAG10 M20	10-14	200	£18.01
TAG10 M25	10-14	200	£19.34
TAG14 M25	14-20	450	£20.86
TAG18 M32	18-25	450	£24.35



P106/30



LSL2/16

Insulated grips available on request

CARAVAN UNITS

IES PART NO.	DESCRIPTION	TRADE
CPU116RCBO	IP44 Unit c/w 1 x 16A 240V Skt 1 x 16A 30mA RCBO	£108.97
CPU216RCBO	IP44 Unit c/w 2 x 16A 240V Skt 2 x 16A 30mA RCBO	£159.21
CPU316RCBO	IP44 Unit c/w 3 x 16A 240V Skt 3 x 16A 30mA RCBO	£221.60
CPU416RCBO	IP44 Unit c/w 4 x 16A 240V Skt 4x 16A 30mA RCBO	£280.59
CPUM16RCBO	IP44 Unit c/w 1 x 16A 240V Skt 1 x 16A 30mA RCBO, 1x Kwh meter	£162.62
CPU132RCBO	IP44 Unit c/w 1 x 32A 240V Skt 1 x 32A 30mA RCBO	£113.45
CPU232RCBO	IP44 unit c/w 2 x 32A 240V Skt 2 x 32A 30mA RCBO	£164.88
CPUM32RCBO	IP44 Unit c/w 1 x 32A 240V Skt 1 x 32A 30mA RCBO, 1x Kwh Meter	£166.48
MOUNTING STAKE	1.5m Galvanised steel mounting stake	£26.37

All hook-up units are supplied complete with a brass gland plate with 2x25mm entries and 2x25mm loop in / out terminals.



CPU116RCBO



CPU216RCBO

The made to order service is a major part of IES business. We will keep you informed on the progress of the job throughout its duration. We combine design and robustness to meet your individual requirements for bespoke hook-up units. No matter how big or small, our in-house CAD designers can meet your exact specification.

The Process:

- Contact the IES technical sales team to discuss your requirements
- Place an order
- We will keep you informed on the progress of the unit throughout its special build. We will endeavour to get your unit to you as quickly as possible
- The unit will be delivered the day after completion and we will deliver the unit direct to you, or your customer free of charge on orders over £150.00

Our special build solutions are tested and are constantly researched and developed to ensure we maintain our position at the forefront of electrical accessories and system innovations.

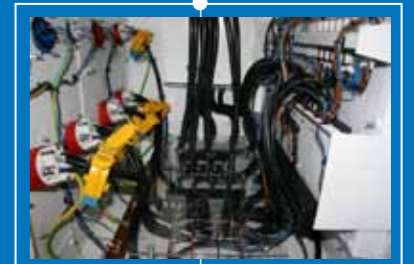

Terms and Conditions

1. APPLICATION OF CONDITIONS

INTEGRATED ELECTRICAL SOLUTIONS a trading name of Import Export Services Ltd. (herein after called IES) supplies goods or services only subject to these conditions and any person or persons seeking to be supplied by IES (herein after called "the customer") accepts that these conditions will govern all relations to the exclusion of any terms contained in any of the customer's documents even if the same purport to provide that the customer's own or some other terms shall prevail and to the exclusion (so far as may be lawful) of all terms, conditions, warranties and representations written or oral express or implied (save those implied by the Sale of Goods Act 1979), or any statutory re-enactment or modification thereof.

2. ILLUSTRATIONS, DESCRIPTIVE MATTER & DIMENSIONS

All descriptions and illustrations contained in IES's, catalogues, price lists and advertisements or otherwise communicated to the customer are intended merely to present a general idea of the Goods described therein and nothing contained in any of them shall form any part of the contract.

DESIGNS

IES's policy is one of continuous improvement. The right to change designs at any time without notice is reserved.

SAMPLES

Notwithstanding that a sample of the Goods may have been exhibited to and inspected by the Customer, it is hereby agreed that such a sample was so exhibited and inspected solely to enable the Customer to judge for himself, the quality of the bulk and not so as to constitute a sale by sample. The Customer shall take the goods at his own risk as to their corresponding with the said sample or as to their quality, condition or sufficiency for any purpose.

3. PRICES

1. All prices listed or quoted are provisional only and are subject to alteration without prior notice and prices charged will be those current at the time of despatch of goods.

2. Prices are quoted exclusive of packing & carriage to addresses in the UK and exclusive of Value Added Tax, which will be charged at the appropriate rate ruling at the time of invoicing.

4. ACCEPTANCE OF ORDERS

No contract for the sale of goods ("the goods") shall be concluded until either IES sends or otherwise communicates to the customer its acceptance of the customer's order or on the delivery to the customer of the Goods, whichever is the earlier. Orders may not be

cancelled without IES's prior written consent first being obtained and then only on payment of such reasonable and proper cancellation charges as IES may decide.

5. DELIVERY

All delivery dates are estimates only and the time of delivery shall not be of the essence of the contract. In no circumstances shall IES be liable to compensate the customer in damages or otherwise for non-delivery or late delivery of the Goods or any of them for whatever reason or for any loss, consequential or otherwise arising there from. IES reserves the right to make partial deliveries and to allocate available supplies amongst customers in times of shortage. IES shall be entitled to deliver the Goods in one or more consignments unless otherwise expressly agreed.

The Goods shall be delivered at the address specified in the Customer's order or if no such address is specified, shall be collected by the Customer from IES's premises within seven days of the date upon which IES notifies the Customer that the Goods or part thereof are ready for collection. IES shall be entitled to make delivery or require collection by instalments as and when such instalments are available to IES and to treat such instalments as a separate contract and to receive payment thereof accordingly.

6. CARRIAGE & PACKING

Packing materials are non-returnable unless otherwise specified by IES. IES reserve the right to choose the carrier and charge for carriage and/or packing.

7. DAMAGE OR LOSS IN TRANSIT

When the price quoted includes delivery, IES may repair or replace free of charge goods damaged in transit or not in accordance with the advice note, providing that in the event of damage or shortage, written notification giving details of such damage or shortage must be sent to IES within seven days of receipt, or in the event of non-delivery, must be sent to IES within fourteen days of the date shown on the advice note. Order number, advice note and date of despatch are required and in the event of failure to give notice within the aforementioned period, the good will be deemed to be in all respects as invoiced.

RETURNS

The return of items cannot be accepted without prior written approval and must be accompanied by a goods return authorisation number, which will be issued at the time of approval. This number must be quoted on all debit/credit notes relating to the return. If such consent is given, a handling charge will be made.

8. INSTRUCTIONS & LABELS

The Customer shall ensure that instructions and/or warning labels on the goods are not removed, altered or covered whilst goods are in his possession and shall not remove any label or plaque affixed to the goods, referring the user thereof to IES's instructions and/or recommendations for use.

9. WARRANTIES & LIABILITIES

IES warrants the Goods will remain free from defects in workmanship and materials for a period of twelve months from date of IES's invoice. IES further warrants that the Goods will be fit for the purposes described in the brochures, technical product information or catalogues of the Manufacturer, but only provided the Goods are used only for the purposes described and in strict accordance with any instructions or warnings issued by IES and/or the Manufacturer, in relation to the Goods.

Save where any defect in the Goods results in personal injury or death to any person, IES's liability for breach of the above warranties or for any negligence on the part of IES, its servants or agents shall not exceed the value of the Contract and shall not under any circumstances extend to any indirect or consequential loss suffered by the Customer as a result of such breach or negligence. The Customer expressly accepts that, in view of the purposes for which the Goods should be used (which are unknown to IES) the above limitation constitutes a fair and reasonable apportionment of liability in the event of any defect in the Goods.

10. PAYMENT

The time specified for payment shall be of the essence of the Contract. Unless otherwise agreed in writing by IES all sums due from the Customer under the Contract shall be paid by the Customer not later than the 30th day of the month next following the month during which IES's invoice is dated.

The Customer shall not be entitled to deduct from or set-off any monies due to IES in respect of the Contract any sum claimed by the Customer against IES whether in relation to the supply of Goods or otherwise.

11. TITLE

Notwithstanding delivery and the passing of risk, the legal and beneficial ownership in the Goods shall not pass to the Customer but shall remain with IES until the Goods and any other sums due under the Contract have been paid for or paid in full by the Customer.

In the event that the goods are not paid for on the due date, IES may, whether or not such right of termination shall be exercised and without prejudice to its rights or remedies at any time, recover the Goods or such parts thereof as shall be in the possession or under the control of the Customer and for that purpose IES and its authorised representatives may enter upon any customer's land or buildings on which the Goods may be situated. Until title to the Goods has passed to the Customer under the above provisions, the Customer shall store the Goods separate and apart from the other Goods so that they are readily identifiable as the Goods, the subject of the Contract. If the Customer fails to store the Goods separately, IES shall have the right of re-possession to remove any goods of similar nature and of equal value to the Goods.

12. RISK & INSURANCE

All Goods shall be at the risk of the Customer from the time of delivery to/or collection by the Customer, his servant or agent or other representative at the agreed point of delivery or collection.

13. FORCE MAJEURE

Neither party shall be liable to the other for any failure or delay in the performance of any obligation hereunder as a result of strikes, lockouts, trade disputes, breakdown of plants, accident or other cause whatsoever beyond the reasonable control of IES or the Customer respective.

14. ASSIGNMENT

IES reserve the right to assign or sub-contract the performance of its obligations under the Contract or any part thereof or to assign the benefit of its rights hereunder. The Contract may not be assigned, sub-let or changed in whole or in part by the Customer without the prior written consent of IES.

15. APPLICABLE LAW

The Contract shall be constructed and have the effect in all respects in accordance with the Laws of England and the Customer hereby submits to the jurisdiction of the English Courts.

Terms & Conditions of Trading

THESE CONDITIONS SUPERSEDE ALL PREVIOUS CONDITIONS AND SHALL FORM THE BASIS OF ANY CONTRACTUAL ARRANGEMENTS ENTERED INTO BY IES FOR THE SUPPLY OF GOODS OR SERVICES AS FROM 1st JULY 2004.

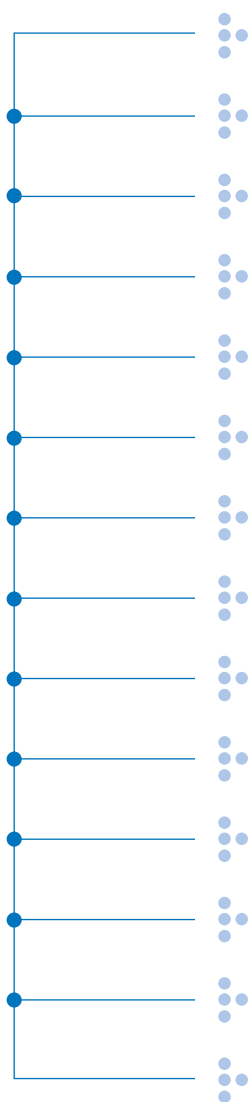

Switchgear

Metal Enclosures

GRP Enclosures

Plastic Enclosures

IP55 Consumer Units

Garage & Shower Units

RCDs / MCBs

Cable Grips

Plugs & Sockets

Interlocked Sockets

RCD Protected Sockets

Combination Units

Caravan Hook-up Units

Special Builds



IES, 1 Portview Road, Avonmouth, Bristol, BS11 9LS

Tel 0845 226 7125. Fax 0117 938 0900. Email info@iese.co.uk

www.iese.co.uk